

Contents

1. **Executive Summary**
2. **What gifts and skills do you have that match what we feel we most need?**
3. **What do we consider to be our strengths and are our challenges?**
 - a. Things we think we are good at:
 - b. Things we think we need help with
 - c. Things we believe should be amongst our future priorities
4. **Wider Context**
 - a. North Chelmsford Mission and Ministry Partnership
 - b. Chelmsford North Deanery
 - c. Chelmsford Diocese
5. **Welcome to our church**
 - a. Our Worship, Services and Activities
 - i. Sunday Worship
 - ii. Weekday Worship
 - iii. Special Services
 - iv. Other Services
 - b. Children and Young People
 - c. Ministries around worship
 - i. Lay Ministry
 - ii. Music in worship
 - iii. Bells and bell ringers
 - iv. Flowers in church
 - d. Prayer, Bible Study and Nurture Groups
 - e. Fun and Fundraising
6. **Reaching Out**
 - a. Communications
 - b. Ecumenical relationships
7. **Parish Description**
8. **Notable Sites within the Parish**
9. **About the Church Building... and a little history**
10. **Church Finance**
11. **The Vicarage**
12. **Appendix : Consolidated list of links for further information**

1. Executive Summary

We are looking for someone who is ready to take on the exciting opportunity of an evolving role, here in Boreham. You will be appointed as the parish priest in our Essex Village as half of your role; the remainder of your time will be working with the new St Francis Community Church in Beaulieu and Channels. Our previous incumbent was also allocated to our parish on a half-time basis, with the other half being similarly filled by other responsibilities.

St Andrew's is part of the newly formed North Chelmsford Mission and Ministry Partnership (NCMMP), the purpose of which is explained further on in this profile. The NCMMP brings with it new challenges and opportunities, as a group of 11 parishes we are seeking ways of working together and supporting each other in mission and worship, whilst retaining individual identities and responsibilities.

St Andrew's is a parish church in the centre of a medium-sized village in mid-Essex. The congregation at our main Sunday service averages 65-70. Our PCC meets bi-monthly, with 12

elected members, in addition to those who serve in ex-officio capacities. We also have four PCC sub-committees, all of which offer an opportunity for non-PCC members to be co-opted.



Boreham has a strong village identity, which its residents are proud of. It is close enough to Chelmsford to feel well-connected, but surrounded by sufficient farmland and countryside to feel rural. The church is at the centre of the village both physically and metaphorically, with formal and informal links to various other organisations, and always endeavouring to play an active and involved role in the local community. However your role evolves, it is intended that your base and your home will be in Boreham.



2. What gifts and skills do you have that match what we feel we most need?

Can you help us to...

1. make better links with the wider community in the parish, helping them to feel valued by the church?
2. release the resources that God has given us for mission in this parish; including lay ministry, vocations and finance?
3. develop social events that bring the community together and explore their potential for mission?
4. offer a varied and inclusive range of worship opportunities, so that we can provide opportunities to bring as many people as possible to God?
5. embrace the opportunity to explore ways in which we can develop our role in the NCMMP so that mission can be enhanced across the wider area?

3. What do we consider to be our strengths and what are our challenges?

Before preparing our profile we undertook research to help us to understand the needs of our congregation and the wider community. We carried out a survey of those who attend all our services, with organisations in the village and via church and village Facebook pages. This has helped us to understand what is valued, what challenges we face and how our priorities should be shaped.



Things we think we are good at:

1. We have been informed by the results of our survey that we are seen as being friendly and welcoming by most of the community
2. We have maintained a good regular congregation, with the help and support of our curate and lay ministers, during the vacancy
3. We have a number of lay people willing and able to lead services, sermons and bible study

Things we think we need help with:

1. We are currently operating with an annual budget deficit; this situation needs to improve; ideally we would like to be in a position to support other churches in our NCMMP
2. Not all members of the local community feel that we are approachable
3. We currently have vacancies on our PCC, which we would like to fill with people who are wanting to play an active role in the management of the church

Things we believe should be amongst our future priorities

1. Creating relaxed opportunities for non-churchgoers to explore the Christian faith, including reinstating a Messy Church service
2. Improving our links with the wider village and what happens here
3. Encourage more non-regular church goers to enjoy the social life and events at church and thereby experience God's love
4. Ensuring that we are as welcoming as we think we are and want to be, at all times. Especially ensuring a positive experience when people are coming to us for the first time and/or because they want a baptism, wedding or funeral in the church
5. Identifying and growing talents and gifts from within the church community



4. Wider Context

North Chelmsford Mission and Ministry Partnership

In 2013 Chelmsford Diocesan Synod adopted a paper entitled 'Reimagining Ministry', which envisaged clustering parishes across the Diocese in 'Mission and Ministry Units'. Accordingly, we have developed a local cluster, called North Chelmsford Mission and Ministry Partnership (NCMMP).

The NCMMP comprises 8 benefices including 11 churches: Boreham; Broomfield; Great Leighs, Little Leighs, and Little Waltham; Great Waltham with Ford End; the Chignals with Mashbury; North Springfield; Pleshey; and Springfield All Saints'. Of these 2 are

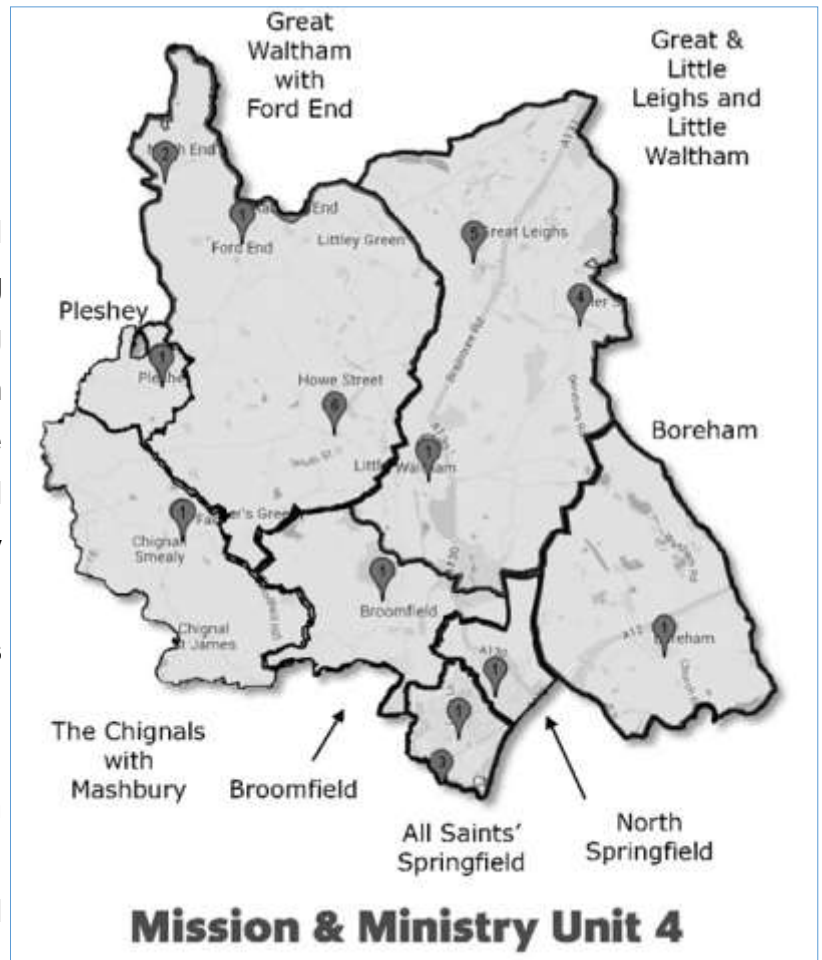

close to Chelmsford City centre, with the others located in more rural village settings.

The NCMMP also includes Beaulieu – a major new housing development of 10,000 new homes. A Bishops Mission Order is currently being put in place and a Pioneer Minister has recently been appointed to serve this area, which has been built on land previously part of 4 separate parishes, including Boreham.

The NCMMP has within it 4 stipendiary incumbents (in addition to the Beaulieu Pioneer Minister and the role at Boreham). There are also 3 Self-Supporting Ministers, 7 Readers, 1 Licensed Lay Minister and 3 Authorised local Preachers.

Chelmsford North Deanery

Things in the Deanery of North Chelmsford are changing quite quickly with the advent of the new Ministry and Mission Partnerships. There is, however, a good sense of collegiality, support and indeed friendship across the Deanery and anyone joining the parish of Boreham will find help and support easy to come by. This is one of the friendliest Deaneries I've ever worked in. I can highly recommend the hard working, caring and supportive people of Boreham.

Reverend Tom Page (Area Dean North Chelmsford Deanery)

Chelmsford Diocese

Please see a letter from Bishop Stephen, on the next page.



In the Chelmsford Diocese we believe that God is calling his church to be a transforming presence. Our vision is that the church - that is the people of God here in Essex and East London - should be a transforming presence in every one of our parishes. These are our priorities –

- To inhabit the world distinctively
- To evangelise effectively
- To hold ourselves accountable to one another and to God for the stewardship of the gospel
- To re-imagine the way we minister so that each ordained minister and each individual Christian discovers their part in God's ministry and so that each church flourishes.

To this end we are looking for priests who are excited by this vision of becoming a church which is itself transformed, and which is becoming a more visible and effective presence in the huge diversity of communities that make up this most exciting and energetic part of England.

There are many challenges ahead of us. We are a diocese generously subsidised by the national church. We need to become financially self-sufficient.

Leadership often seems distant. We are creating patterns of leadership that are closer to the parishes. And we are looking to develop missionary leadership at all levels of church life.

Nearly half our clergy will retire in the next ten years. We need to find out how to minister with fewer stipendiary clergy and with a re-imagining of how stipendiary ministry works.

We need to re-organise the way parishes relate to each other and we are calling mission and ministry units. Some of our congregations still think ministry is what Vicars do.

We have a vision of ministry where the whole people of God are involved in the whole of God's ministry. We are also experimenting with new forms of authorised lay ministry. Levels of church going are below the national average. We need to get evangelism into the agenda and into the lifeblood of every church. In 2016 we invited every benefice to put on a weekend of mission and outreach, and we are now training people in every church for this ministry.

One of our aspirations is that every benefice should have a trained lay evangelism enabler. Despite planning for a future with fewer stipendiary clergy, we remain as committed as ever to the local church. And what is the local church, but that community of men and women gathered around Christ, and living and sharing the gospel in the networks and neighbourhoods of their lives? But we need priests to lead and to serve.

We know we need to change. We can only be a transforming presence when we have allowed God to transform us. Therefore at the heart of all we do is a longing for intimacy with God and a renewed life of prayer.

First and foremost a priest is a minister of the word and sacrament. All ministry flows from this. But a priest shares the ministry of the bishop, therefore presbyteral ministry will increasingly be a ministry of oversight, guiding, nurturing and directing the mission of God's church in the communities we serve.

It is an exciting time to be part of God's missionary movement for the world, and the Diocese of Chelmsford is an exciting place to serve. We have a clear vision and we are looking to appoint clergy who will share this with us. In every parish we long to see each person and each community grow in faithfulness and ministry so that together we may serve in the world and Christ may be made known

+ Stephen

Stephen Cottrell Bishop of Chelmsford

5. Welcome to Our Church

On the outside...

The church stands aside the narrow road (Church Road) which runs through the oldest part of the village. A covered path (ambulatory) leads from the road to the main entrance (south porch) and is a distinctive feature of the church building. The fine Norman tower, with its clock and eight bells commands a central position amid the surrounding conservation area, and is floodlit at night.



And inside, there is always a lot going on...

Our Worship, Services and Activities

Our parish benefits from having an Authorised Local Preacher and two Pastoral Assistants. We do not currently have any Licensed Lay Ministers.

We offer a wide range of services, both on Sundays and during the week. We are open to new experiences and enjoy a taste of new worship styles and cultures.

Sunday Worship

Our regular Sunday worship follows the pattern:

1st Sunday	10.30am	Family Service
	5.30pm	BCP Holy Communion
2nd Sunday	10.30am	CW Holy Communion
3rd Sunday	10.30am	Morning Prayer
	5.30pm	BCP Holy Communion
4th Sunday	10.30am	CW Holy Communion
5th Sunday	10.30am	Holy Communion

Weekday Worship

Our regular weekday pattern of worship includes:

- 8.30am Morning Prayer twice weekly
- 10.00am Holy Communion CW, monthly on the first Wednesday
- 7.00pm Wednesday evening service which varies between a Holy Communion CW and a Sacred Space reflective service
- Healing Prayer Service on the second Thursday of every month, where prayers are

said for those who are unwell and the names from the memorial book for that month are read out and candles lit in their memory. Our Pastoral Assistant plays an active role in leading this service along with another member of our pastoral team. We conclude our prayer time with a simple soup and roll lunch and it is hoped that this service will continue to be a real sacred space and valued by those who attend.

Special Services

In recent years we have offered **Compline Services** on the first three weekdays of **Holy Week** and weekly during **Advent**.

- At **Easter** we have introduced a Sunrise service on Easter Day which has been enjoyed by approx. 20 people – perhaps motivated by the bacon rolls served afterwards!
- At **Christmas** we have seen our pre-Christmas congregations grow to the extent that we have increased the number of services to enable people to worship safely and meaningfully – this includes two carol services the Sunday before Christmas and two services on Christmas Eve.

Other Services

We take opportunities to share worship with other organisations - we host the local primary school on four occasions each year; partner with the uniformed organisations on Remembrance Sunday, St George's Day and at Christingle, and join with a local Hospice (Farleigh, which is based within NCMMP and has a charity shop within our village) for Light up a Life.

Children and Young People

Every Sunday in term time, for an hour before Sunday worship, 5-8 children age 3 upwards come together for bible stories and craft activities in what we call **Early Bird Sunday School**.

Each Tuesday our **Edward Bear Group** meets in Church, from 10.30am till 12noon with an average 14-25 children – even during the school holidays! Children play with toys when they arrive, with crafts and colouring for them to do as well. After the toys are tidied away we have a small service with a story, songs and prayers. Our meetings are enthusiastically attended with lots of fun and noise! We welcome children from birth until they go to school and it is lovely to see the older children who come back to see us in the school holidays.

Our once successful **Messy Church** sadly ended in July 2017, owing to a lack of volunteers to run it. This service had been lay-led, and we would like to see it's return at some point in the future, as it was very well-received by families in the community.

We have previously run Youth Group sessions on a periodic basis, but none have taken place in the last twelve months. This is another activity that the PCC would like to support if volunteers can be found.

Ministries around worship

Lay Ministry

We have a small number of lay people who enjoy leading worship, including occasional Morning Prayer services, Compline, Sacred Space reflections and Bible Study. We also encourage people to consider new ministries, both lay and ordained, and place great value on training including the Course in Christian Studies, Discipleship and training leading to authorised preaching, pastoral support and evangelism.

Music in Worship

Music plays a key role in our worship at St Andrews. As well as supporting our Sunday morning worship, our talented choir perform periodic concerts in the Church. We have two organists who play on Sunday mornings; on first and third Sundays our 3-strong Worship Band (piano, guitar and clarinet) provides our musical accompaniment.

Bells and Bell ringers

We are proud to have an active team of Bell-ringers. Our regular ringers practice weekly on a Tuesday evening, and ring for Sunday morning worship as well as weddings. We are pleased to welcome visiting ringers and our Bell-ringers also enjoy ringing for special occasions – quarter peals are rung to mark significant celebrations.

Flowers in Church

We have a dedicated team of flower arrangers who arrange altar flowers each week and decorate the church for significant festivals. At Easter, the area surrounding the High Altar is transformed into an Easter Garden, providing an atmospheric setting for services in Easter week. The flower arrangers have also provided flowers for a number of weddings. Every two years we hold 'Boreham in Bloom' – a combination of flower festival and open gardens, which is one of our main fundraising events.



Prayer, Bible Study and Nurture Groups

- **Alpha** – a number of Alpha Courses have taken place in our parish, the most recent in early 2017, with 29 participants.
- **SHAPE** – we have run two SHAPE courses (a Diocesan course, designed to help parishioners to explore their faith and to explore what their role and calling in the Church might be.)
- **Lent groups** - a number of valued Lent groups are held annually, in the church hall and in people's homes, at varying times of day, to maximise accessibility
- **Bible Study** – A regular, lay-led Bible Study group developed out of the SHAPE and Lent courses which is highly valued by those who attend.
- **Men's Breakfast** – meets on a quarterly basis, with food and a speaker

Fun and Fundraising!

We hold a number of social events throughout the year, which aim to offer opportunities for social interaction as well as to fundraise for the church and other charitable causes. Most of them involve food, usually including cake!

Some of the recent events we have been proud to host include:

- A **Pudding Party** – soup and a roll, bring and share puddings and silly games!
- A **Village Show and Fete** – held on August Bank Holiday in the alternate year to Boreham in Bloom; the church runs this event for the whole village and in 2016 over 200 entries to the show were received.
- Once a month our **Afternoon Teas and Chats** offer company for those who would otherwise be lonely on a Sunday afternoon.
- Thursday **Film Club** runs once a month, reaching out to those on the edge of the worshipping community. This attracts up to 25 people, and through the work of our pastoral team, these include those who are bereaved or who are unlikely to be able to go and see a film in town.

Where possible we use our Church Hall (the Pelly Room, which is consecrated so that services can be held there) for events, but its size is limiting. We own marquees and a team of volunteers put these up in the Vicarage Garden (as long as our new incumbent is happy for this!) for larger events. We also use the church building itself,

although there are limited facilities within the building – seeing social events held there as a way of breaking down the barrier for people to come into the building.



6. Reaching Out

The church is popular for **weddings**, often in association with booked Receptions at Boreham House.

We support the nearby **Church at Car Boot Sale** – a ministry run by a group of churches, taking place in our parish at the Boreham Boot Sale.

We have several links with the **Church abroad**, fundraising for various projects in the Diocese of Marsabit in Kenya. We have also welcomed visiting clergy from this Diocese.

The long established links with the community at **New Hall**, now a thriving Independent School, need to be continued. In recent years the Priest at St Andrew's has provided Holy Communion there twice per term and has supported Confirmation Classes. The chapel there is used for confirmations from time to time parish joins pupils for confirmations.

Communications

We have a weekly pew-sheet and bi-monthly magazine. We also have a website (with room for improvement), Facebook group and twitter account. We do our best to reach out to the community, but recognise that we could do better. We love to welcome new people to services and events, but know that we need to do more to find out what is needed so that we can endeavour to meet these needs. A quarterly Village News Booklet is delivered to all households and contains details of church services and upcoming events.

Ecumenical relationships

Redeemed Christian Church of God

The RCCG meets in Boreham Village Hall, and its leader, Pastor David, has been keen to engage and work alongside St Andrew's. To date there has been no formal working agreement, but we have been pleased to acknowledge the positivity of an additional Christian presence in the village and Pastor David has been welcomed to a number of events that we have hosted.

Essex Police – parish presence and Chaplaincy opportunity

Essex Police have a base within our parish boundary, where the Operational Support Unit, as well as the Police Helicopter, are based. Representatives from Essex Police often attend key services at our church, such as at Christmas and Remembrance Sunday. Our Minister traditionally leads a short annual service of remembrance at an American War Memorial sited outside the entrance to the Police Helicopter station, and we are frequently welcomed for tea and a tour after this service. Both our previous Priest-in-Charge and our Curate have opted to offer Chaplaincy services to Officers and staff at these two bases – including leading annual Carol Services – something the Churchwardens and PCC have supported.

7. Parish Description

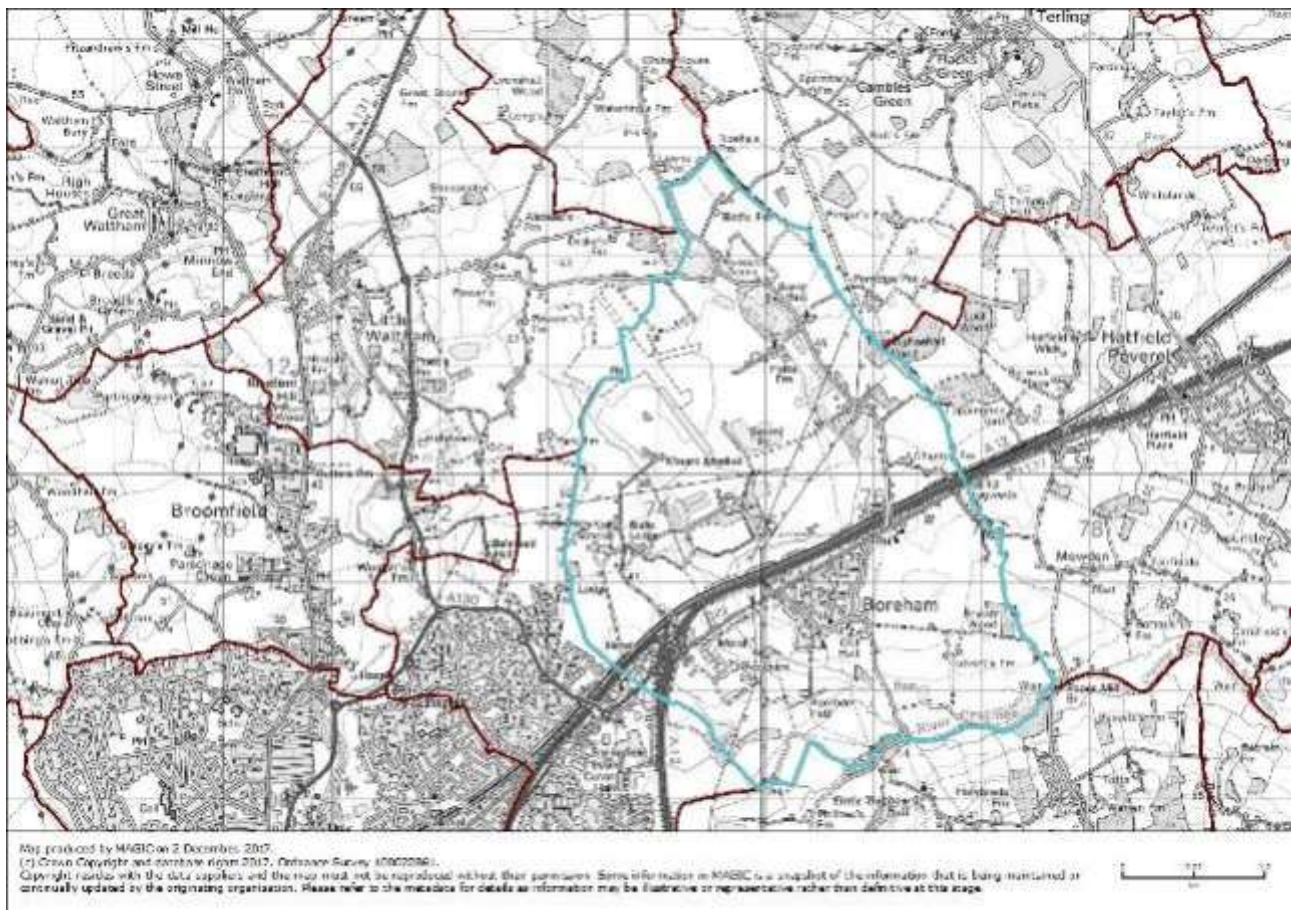

The civil parish boundary is denoted by a thin blue line.

A detailed description of the parish can be found on our website at www.borehamchurch.org.uk/boreham_parish.htm

The Parish of Boreham is located 3.7 miles north east from the City of Chelmsford, covers an area of approximately 6 sq. miles (3840 acres) and has a population of approximately 4,000. The village, which lies on a Roman Road, has over 50 buildings in the parish which are of special architectural and historical interest.

Community Facilities

Boreham is a thriving community with a Village Hall, two recreation grounds, a parade of shops which contains a general store, charity shop, hairdressers and a post office. Shops located elsewhere in the village include a dry cleaner, an ironing shop and a tyre shop. Also located within the village are a primary school, a doctor's surgery with dispensing chemist, together with several other shops including a family run butchers shop, a gun shop, village store, a barber and four public houses. The residents of Boreham benefit from numerous community groups and activities for all ages. During the summer one of the largest Boot Sales in East Anglia is run on farmland at the edge of the village at which some members from local churches, including Boreham, run a coffee kiosk.

Transport links

To the west of Boreham lies the A12, which is the main trunk road linking London to East Anglia. The Greater Anglia railway line, which runs between Liverpool Street and Norwich, passes the village following the same route as the A12, the nearest station being Hatfield Peverel around two miles to the east, with a journey time of 40 minutes to London Liverpool Street. The number 72 bus currently maintains a half hourly service between Chelmsford and Witham (Monday – Saturday).

Surrounding countryside

There are some fine walks in the countryside immediately outside the village, some of which provide links to North Springfield, Little Baddow and Hatfield Peverel. The local farmland is slightly hilly and is mostly used for cereal farming although there are a few woods and an Osier bed. A stream skirts the Village and flows into the River Chelmer.

Homes and housing

The majority of houses in the village are modest three or four bedroom homes, with many of these being built in the 1970's. There are some areas of social housing but the majority are owner occupier or privately rented. Cleves Court, a small two storey block of flats with a resident warden, are rented to the elderly. One large scale development, currently only in the outline planning stage, will see a significant number of houses (estimated at 140) being built on farmland at the eastern end of the village. The northern fringe of the parish extends into what is now a new large housing development known as Beaulieu Park.

Education

Boreham benefits from having a Primary School (Infant and Junior boys and girls, aged 4 - 11 years). The number of pupils on Roll as of September 2017 is 221. The Published Admissions Number for Academic year 2017/18 is 30. There are also 2 nursery schools in the village, Small Steps and the Garden Nursery. Children reaching the age of 11 are transferred to one of a number of Secondary Schools in the catchment area, including grammar and independent schools.

Boreham Statistics

Information regarding the population demographics in Boreham can be found by accessing the following link <http://www.chelmsford.anglican.org/advice/parish-spotlights>

According to the 2011 Census the population of Boreham is older than the national average, but younger than the Essex average. Boreham has 20% more Higher and Intermediate managerial, administrative or professional households than the national average and a higher rate of home ownership than the national average, which suggests that Boreham is a relatively affluent area. As with most rural villages in Essex there are known to be pockets of hidden deprivation.

8. Notable sites within the Parish

Boreham House

Built in 1728 as a private mansion for Sir Benjamin Hoare, the house has had several alterations and has had a number of uses during its existence. Now a listed building it has, since 2008, been operated as a wedding venue.



Boreham Airfield

Built in 1943 the airfield opened in 1944 for the use of the United States Army Airforce. During its occupation it was primarily used by the 394th Bombardment Group flying B26's (Marauders) and as a Troop Transport Airfield for the deployment of British Paratroopers into Germany. It was closed in 1945. Today the airfield is partially used as for gravel extraction and home to the Essex Police Support Unit and Police Helicopter Unit. A Memorial for the 61 Aircrew who died while flying from Boreham Airfield is located at the entrance to the site.

New Hall

Located 1 mile north west of the village New Hall School, once a palace of Henry VIII. The king rebuilt the original house in brick and gave his new palace the name 'Beaulieu'. It now operates as an Independent Catholic school for both boarder and day pupils.



9. About the Church Building ... and a little history

We are fortunate that the Church, the Church Hall and the current Vicarage are all conveniently situated on a single site in the centre of the village.

Described as “**More curious than beautiful**” by Nikolaus Pevsner (*Buildings of England, 1954*), the church is Grade 1 listed and full of interest and mystery.

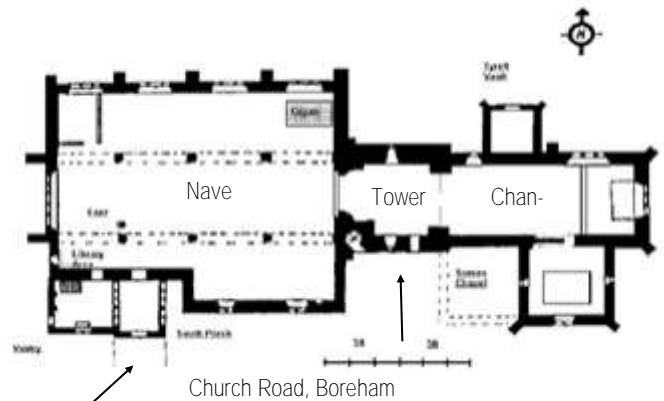

Ground plan of the church, showing the almost square nave, separated from the chancel by the tower, but with no transepts thus giving the building a linear footprint.

The two additions to the chancel are tombs.

The latest Quinquennial Inspection took place on 1st November 2017.

The findings were that during the next five years only minor repairs to woodwork and stonework are required, but sometime within the next quinquennium (2022-2027) there will be a need for substantial attention to the chancel roof and the flat covering over the north aisle.

Most of the principal services are held in the nave where there is a movable altar to the east adjacent to the organ. The central position of the tower means that the chancel can be used as a quiet chapel, accommodating up to thirty people. There is a vestry kitchenette in the south-west corner from where light refreshments can be served. Meeting and greeting goes on just inside the entrance from the South Porch, the main doorway from the outside covered way (ambulatory). This and the doorway at the foot of the tower are wheelchair accessible.

Reordering in the late 1960s brought the present organ, pulpit and choir to their current positions in the nave. The carved wooden ambry in the chancel was made locally and installed in 2011. Electric heaters are fitted in the chancel area. A new gas warm air heater for the nave was fitted in 2008 and new sound system installed in 2016.

There are two wartime memorials and record books commemorating those men from Boreham lost in World War I and in World War II, and in the churchyard there are two war graves.

A more detailed account of the historical features of the church may be found on the church website: www.borehamchurch.org.uk/church_history.htm

Outside the church building the churchyard is open for burials and disposal of cremated remains. There is also an extended churchyard area opposite on the other side of Church Road, which is largely full but is still officially open. Both areas are kept in reasonable order and used regularly by people attending graves. There is a quiet memorial area to north of the church building with seating.

Across the driveway, which leads to the present Vicarage, the Parish Meeting Room, locally known as the “Pelly Room,” was fashioned from the old vicarage stables, the money being provided by Miss Pelly. The building was reconstructed to modern specifications including appropriate cloakroom facilities following a fire in 2005, and was consecrated by the Right Reverend Bishop Laurie Green for church use.

Realistically it accommodates up to fifty people, and is in regular use both for internal purposes and hire for children’s parties and by other village groups e.g. Women’s Guild, hand-bell ringers, local Conservation Society and Twinning Association meetings.

The present church community is very aware of the responsibility of sustaining and growing patterns of worship here. This church is alive and vibrant, with a wide range of services and activities. The building itself however, presents different challenges and relies heavily on legacies and gifts for the upkeep, yet also offers some exciting possibilities for further re-ordering to make better use of the space available.



10. Church Finance

We are very grateful to those who give money to our church, particularly those who give regularly. Nevertheless our income is barely sufficient for us to pay our Parish Share in full and meet our other commitments. We do have a number of restricted funds that allow us to maintain the fabric of the building, support development, etc.

Throughout the year we have special collections to support other charities like CHES, Children's Society, Red Cross, Ava Chaplin.

Unrestricted Income	£	General Expenditure	£
Stewardship	19,562	Parish Share	24,141
Offerings	2,480	Other Expenses	20,371
Events	4,622		
Other Income	13,763		
Total	40,427	Total	44,512

Numbers are for September 2017 YTD

Other income includes: Donations (from Weddings, Baptisms, etc.) and Fees

Other Expenditure includes: Utilities, Fees, insurance, etc.

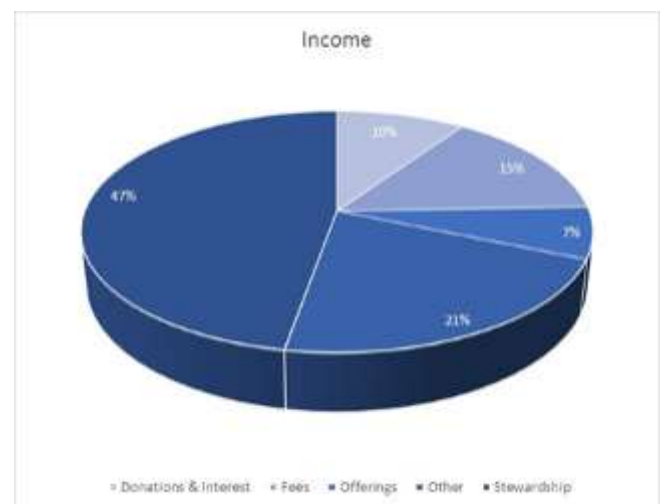
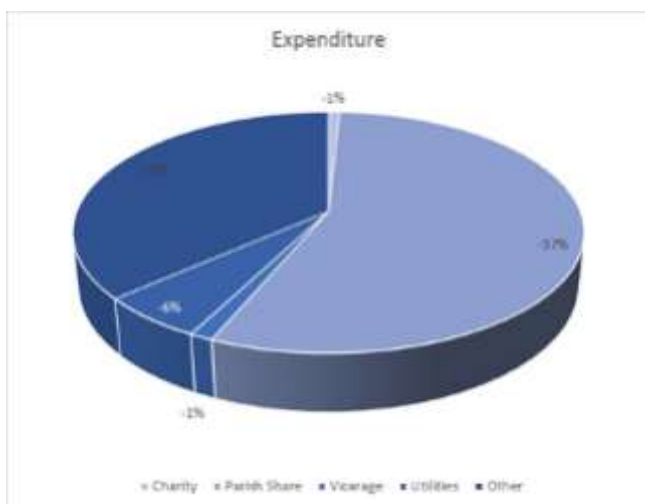

The PCC have agreed in principal to undertake a stewardship campaign to encourage giving – of time or money, whichever is affordable – to support both the mission of the church and maintenance of the church building. Consideration is still being given to the timing of this.

11. The Vicarage



The Vicarage was built in the early 1970s and is set in the middle of a large plot just behind the church, access is from a shared drive beside the Church, and behind the Pelly Room, adjacent to Church Road. It is a spacious house with gas central heating and upvc. windows throughout.

The accommodation comprises a reception hall with the study and downstairs cloakroom, double locking glass doors lead through to the internal entrance hall with stairs and double doors leading to the back garden. There is a spacious lounge with patio doors and fire place, and a separate dining room, both rooms have folding doors that can be opened to make an open plan living area with parquet flooring throughout.



The large well-appointed kitchen has a range of fitted base units and wall cupboards, a pantry, fitted under cooker, dishwasher and large refrigerator and has ample space for a table and chairs.

There is a rear lobby housing a utility area and generous storage area with access to the attached garage and back garden.

Upstairs there are four good sized bedrooms all with fitted cupboards, one with a fitted wash hand basin. The stairs and three of the bedrooms have fitted carpets. There is also a family bathroom and separate toilet and a large fitted airing cupboard housing the hot water tank.



The garden has a large lawn area that has previously been used for church social events, it has some flower beds and fruit trees and is mostly bordered by mature trees.

There are wildlife areas with a pond and natural stream running through the garden.

Because of its central position in the village it is close to the primary school, doctors' surgery, general shop and bus stops, and within walking distance of the three great places to eat out!





12. Appendix

Consolidated list of links for further information

Referenced in the Parish Profile

- ⇒ [Detailed description of the parish](http://borehamchurch.org.uk/boreham_parish.htm)
http://borehamchurch.org.uk/boreham_parish.htm
- ⇒ [Detailed account of the historical features of the church](http://borehamchurch.org.uk/church_history.htm)
http://borehamchurch.org.uk/church_history.htm

Other sites of interest

- ⇒ [Boreham Parish Council](http://www.borehamparishcouncil.co.uk/) <http://www.borehamparishcouncil.co.uk/>
- ⇒ [Diocese of Chelmsford](http://www.chelmsford.anglican.org/) <http://www.chelmsford.anglican.org/>
- ⇒ [Chelmsford City Council](https://www.chelmsford.gov.uk/) <https://www.chelmsford.gov.uk/>

